

FrameKlamp™

- FrameKlamp™ SlideChannel™ wall hangers allow you to fine tune whiteboard position, left to right, on your wall.
- Fastens top and bottom of board tightly to your wall.

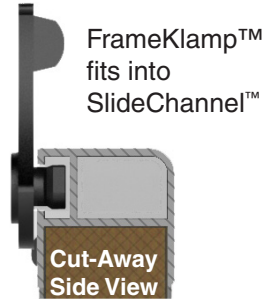

**FrameKlamp™ Installation Instructions**

1. Using a level, mark wall at desired height for top edge of your board and at appropriate wall stud locations (X) for FrameKlamps™ (figure 1).
2. On back of board frame, measure distance (H) between top and bottom SlideChannels™. Mark wall at distance (H) and at appropriate stud locations (figures 1 & 1a).

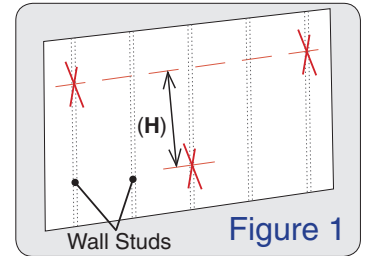

Figure 1

3. Fasten FrameKlamps™ at marked locations using fasteners appropriate for your wall type (figure 2). Fasteners are not included.

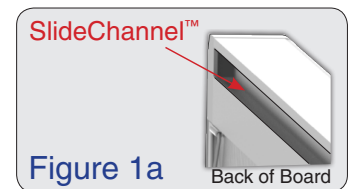

Figure 1a

4. With FrameKlamps™ in vertical (unlocked) position, install board over FrameKlamps™, as shown (figure 3).

Note: Board Hangers are not used with FrameKlamp™ option.

5. Slide board left or right, if necessary, for best location, then pivot FrameKlamps™ into locked position (figures 4, 4a & 4b).

**Caution:** Lightly hold board to wall when adjusting left to right.

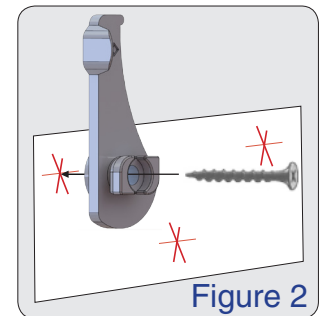

Figure 2

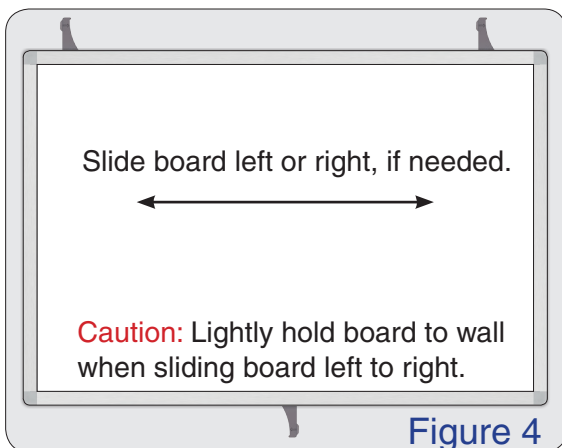

Figure 4

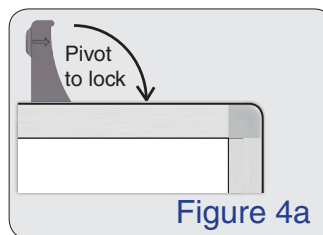

Figure 4a

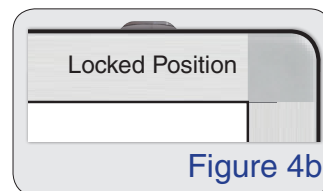

Figure 4b

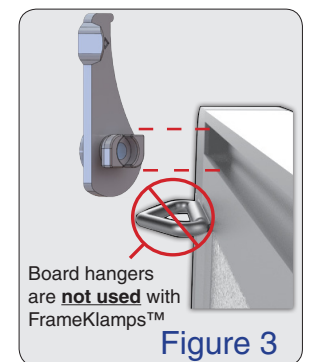

Figure 3

For more information:  
**See Video** →

[magnatag.com/boardinstall](http://magnatag.com/boardinstall)

